

LED Mini-SealLite®

- Virtually Zero Maintenance With 50,000 Hour LED Lifespan
- Highly Vibration and Shock Resistant
- Over 4x as Efficient as Comparable Halogen Lamps
- 6500°K White LED Penetrates Farther Than Halogen Lamps
- Also Available as Blue, Green, Red, or UV
- Safe to Operate in or out of the Water



DEEPSEA
POWER & LIGHT®

LED Mini-SeaLite®

SPEC REV A 4/01/2010

The revolutionary LED Mini-SeaLite from DeepSea Power & Light will change the way you look at underwater lighting. Gone are the days of downtime caused by lamp changes.

LED Mini-SeaLites have a 50,000 hour lifespan and are incredibly resistant to shock and vibration. The LED Mini-SeaLite's high color temperature LEDs and state of the art reflector design give you the ability to put light where you need it, reducing the amount of wasted light that is often experienced as backscatter.

The Mini-SeaLite's compact size, rugged design, and light weight make it the perfect choice for helmet or mask mounted applications. The 6000m depth rating means that LED Mini-SeaLites are equally suited for deep AUV and ROV applications.

MECHANICAL				
Housing:	Anodized Aluminum (6061-T6)			
Port:	Sapphire			
Outer Diameter:	4 cm (1.59 in.)			
Overall Length(w/o conn.):	12.8 cm (5.04 in)			
Weight in Air:	0.5 kg (1.08 lbs)			
Weight in Water:	0.3 kg (0.64 lbs)			
ENVIRONMENTAL				
Rated Depth	6000 meters			
Operating Temperature:	-10 deg. C to +40 deg. C			
OPTICAL				
Colors:	White	Green	Blue	UV
Lumens in Water:	850 lm	N/A	N/A	N/A
Color Temperature:	6,600° K	535 nm	485 nm	365/405 nm
Beam Pattern:	Spot: 20° / Flood: 60°			
ELECTRICAL				
Input Voltage:	10-32 VDC			
Current:	1.83A @ 12 VDC			
Power:	22W			
LED Lifespan:	50,000 hours			
Dimming:	Fully dimmable using 0-5 VDC analog control			

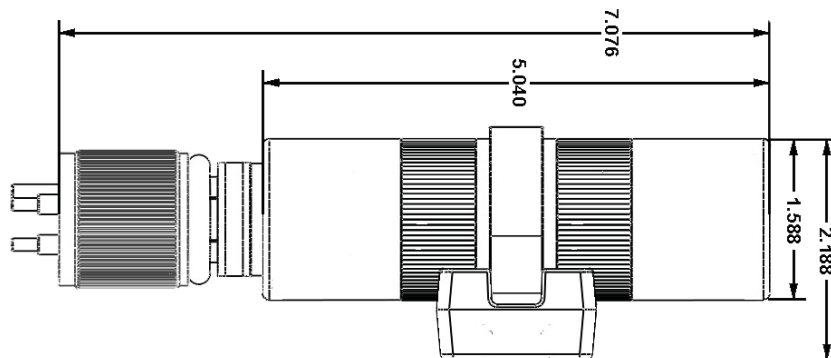

Specifications subject to change without notice.

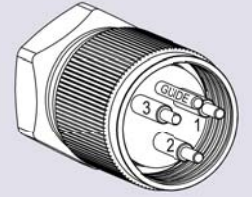

BH3MP

(1=Hot, 2=Neutral, 3=Ground to shell)

BH3MP(LV Dimming Option)

(1=Pos, 2=Neg, 3=Pos 0-5vdc control)

(NOTE: 0-5vdc Control to ground to Pin 2)

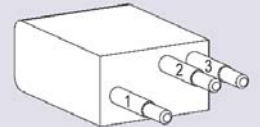

LPBH3MP

(1=Hot, 2=Neutral, 3=Ground to shell)

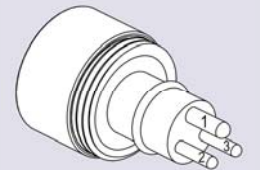

XSG3BCL

(1=Ground to shell, 2=Neutral, 3=Hot)

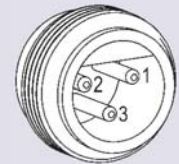

1503

(1=Hot, 2=Neutral, 3=Ground to shell)

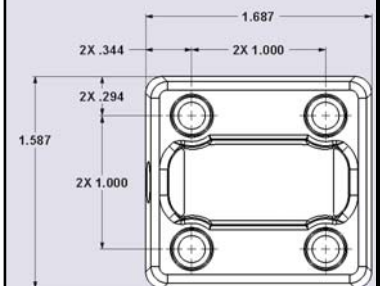

DSPL ENG 712-014
rev 100407



DEEPSEA
Power & Light®

4033 Ruffin Road
San Diego, CA 92123
ph: (858) 576-1261

www.deepsea.com
info@deepsea.com
fax: (858)576-0219