

# Pressure Relief Valve

- 6km or 11 km Depth Rated
- Ultra-small
- Easily Adjustable 2-15 PSI Differential
- Also Functions as Vacuum Port



**DEESEA**  
POWER & LIGHT®

# Pressure Relief Valve Specifications

SPEC REV A 3/31/10

DeepSea's versatile pressure relief valve can be used on instrument housings, battery packs, and other applications requiring venting. Only 1.85 cm (0.725 in.) diameter by 1.91 cm (0.75 in.) overall length, this valve is rated 6,000m (Anodized Aluminum or 316 SS) or 11,000m (Ti6AL4V). The valve's release pressure can be easily adjusted and can also serve as a vacuum port. A dry spring design is used.

Pressure Relief Valve Specifications	
<b>MECHANICAL</b>	
Material:	Ti 6AL-4V, 6061-T 6 Al or 316SS (passivated)
Diameter:	1.85 cm (0.725 in.)
Length:	1.91 cm (0.75 in.)
Weight in Air:	11.7 g (0.42 oz.)
Threads:	7/16"-20, with O-ring face seal
<b>ENVIRONMENTAL</b>	
Depth:	11 km (Ti); 6 km (Al, SS)
Temperature:	-20° C to 200C (-4° F to 392° F) (Optional to 500° F)

## DIMENSIONS

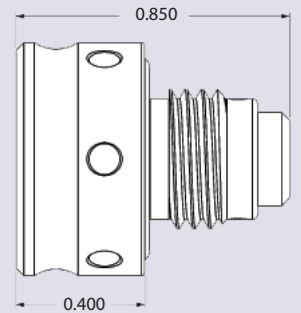
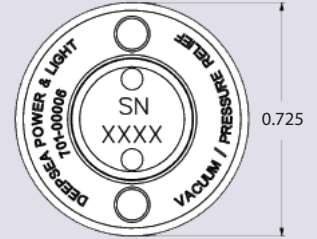

## CRACKING PRESSURE CHART

Setable 2 psi to 15 psi (or closed)

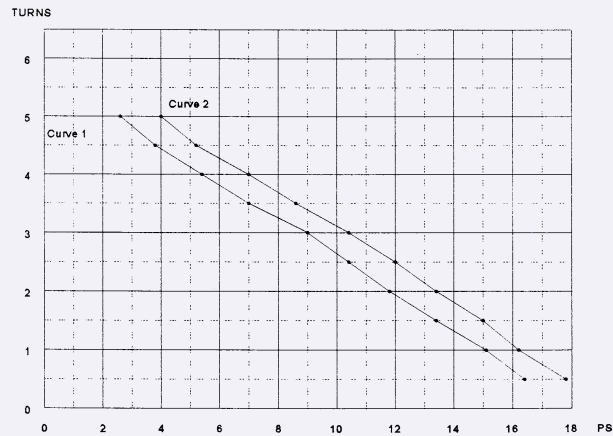
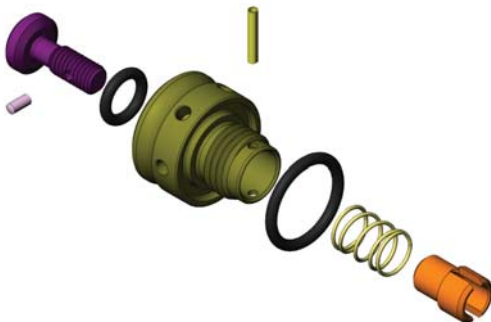
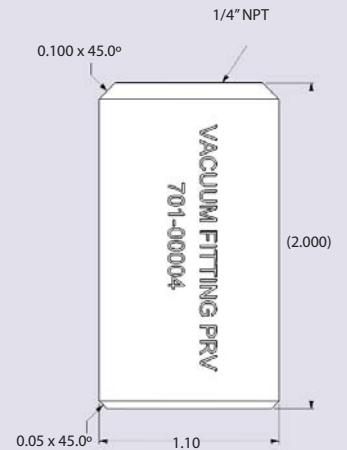

Chart shows pressure for # turns away from closed position and indicates the increase in setting from testing in Air (curve 1) to testing in Water (curve 2).

## EXPANDED VIEW



## ACCESSORIES



VACUUM FITTING  
701-0004

UNIVERSAL INSTALL TOOL  
701-00020

*Specifications subject to change without notice.*



**DEEPSEA**  
Power & Light®

4033 Ruffin Road  
San Diego, CA 92123  
ph: (858) 576-1261

www.deepsea.com  
info@deepsea.com  
fax: (858)576-0219

DSPL ENG 701-000